



Ahead of the Curve®

# Devastating.



## Editors' Choice

– 2008, 2009, 2010, 2011, 2012 & 2013, *The Absolute Sound*

**The Gotham g213 produces state-of-the-art bass that will improve the highest of high-end systems. I've heard no other subwoofer that can match it.**

– Jeff Fritz, *Ultra Audio*.

**There is apparently information in the subsonic region that fills out the sound of a concert hall. Once you've heard it, you can't go back.**

– Jacob Heilbrunn, *TONEAudio*



# GOTHAM®

Your first look will tell you that you are looking at something very special... your first listen will confirm it beyond a shadow of a doubt.

The beauty of the Gotham® extends well beyond its exotic design and exceptional craftsmanship, and aims right at the core of musical and cinematic enjoyment.

With limits well beyond the needs of the typical home theater application, a Gotham® delivers a weight and integrity of reproduction that can only come from a system that is always in control. Its ability to convey subtleties is as impressive as its prodigious output capabilities.

The luxurious, handcrafted gloss-black finish is complemented by machined aluminum and stainless steel

accents for a look and feel that is elegant and spectacular at the same time. More importantly, the beautiful cabinet houses a pair of JL Audio's highest-technology subwoofer drivers.

When demanded by program material, the Gotham's prodigious amplifier can deliver voltage equivalent to 3,800 watts of RMS power to take full advantage of the twin drivers' four inches of peak-to-peak excursion capability.

Listening to a Gotham® reveals an entirely new dimension of subwoofer performance... a dimension so satisfying that listening to lesser subwoofers will forever become an act of compromise.

## Gotham® g213 Features:

### Unbalanced Inputs:

Stereo or Mono (two RCA jacks)

### Balanced Inputs:

Stereo or Mono (two female XLR jacks)

### Output To Slave:

Balanced (one male XLR jack)

### Input Modes:

Master or Slave

### Level Modes:

Reference (fixed gain) or Variable from full mute to +15 dB over reference gain

### Power Modes:

Off, On or Automatic Signal-Sensing

### Light Modes:

Off, On or Dim

### Low Pass Filter Mode:

Off, 12 dB per octave or 24 dB per octave

### Low Pass Filter Crossover Frequency:

Variable from 30 Hz – 130 Hz

### Polarity:

0 or 180 degrees

### Phase:

Variable from 0 – 280 degrees

### E.L.F. Trim:

Variable from -12 dB to +3 dB at 25 Hz

### Automatic Room Optimization (A.R.O.):

with included, laboratory-grade calibration microphone, defeatable

## Gotham® g213 Specifications:

### Enclosure Type:

Sealed, with non-parallel walls

### Drivers:

Twin 13.5-inch (nominal diameter)

### Frequency Response:

19 – 200 Hz (±3dB)

### Effective Piston Area:

214.70 sq. in. (0.1386 sq. m)

### Effective Displacement:

773 cu. in. (12.7 liters)

### Amplifier Power:

3800 watts RMS short-term

### Dimensions\* (H x W x D):

34.13 in. x 21.50 in. x 24.00 in.  
867 mm x 546 mm x 610 mm

### Net Weight:

360 lbs. (163 kg)

### Cabinet Finish:

High-Gloss Black

### Built in USA

with imported and domestic components

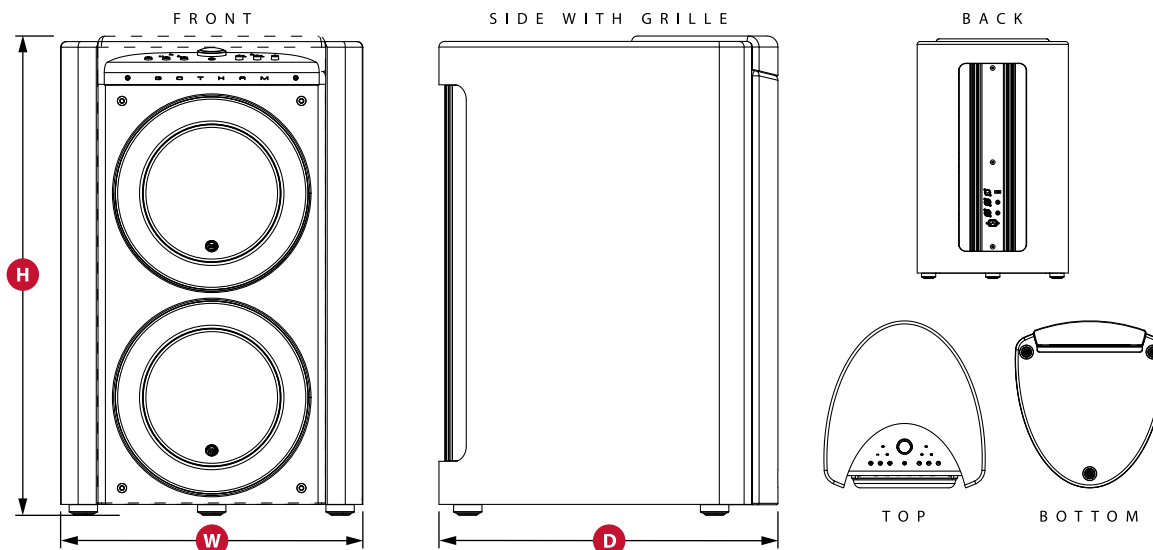

\* All height dimensions include feet, depth dimensions include grilles.



"JL Audio", "Ahead of the Curve", "Gotham", "Fathom" and the JL Audio logo are registered trademarks of JL Audio, Inc.

©2013 JL Audio, Inc. • U.S. PATENTS: #5,734,734 #5,949,898 #6,118,884 #6,229,902 #6,243,479 #6,294,959 #6,501,844 #6,496,590 #6,441,685 #5,687,247 #6,219,431 #6,625,292 #D472,891 #D480,709 Other U.S. & Foreign patents pending. Due to our policy of continuous product development, all specifications are subject to change without notice.

[www.jlaudio.com](http://www.jlaudio.com)

10369 North Commerce Parkway • Miramar, Florida • 33025 • USA



SKU#97185 09-2013  
Printed in U.S.A.